

Pump

DC 12V 12L/min

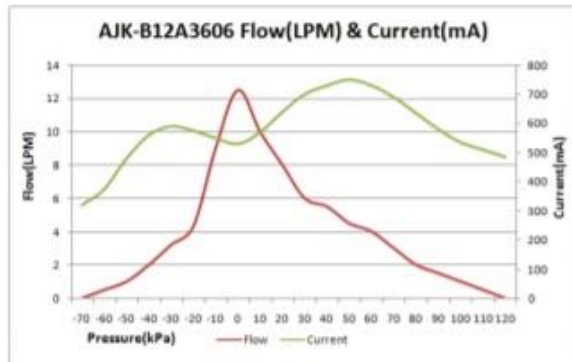
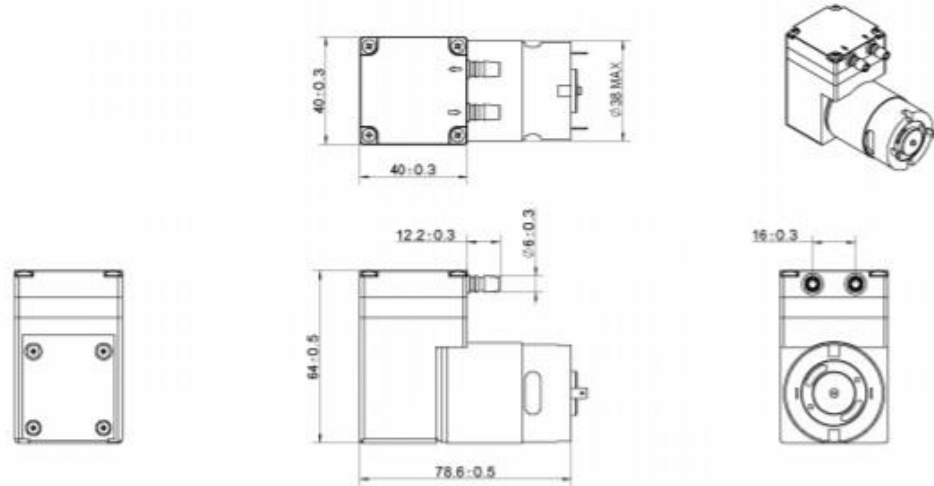

## Product Specification

Rated Voltage	Rated Current	Free Flow	Pressure	Noise	Load
DC 12.0 V	< 800 mA	> 12.0 LPM	-70~110 KPa	< 68 dB	Air & Vacuum
DC 24.0 V	< 500 mA	> 12.0 LPM	-70~110 KPa	< 68 dB	Air & Vacuum